

RBU

The right choice when extra power is required to take care of larger debris or remove waste products through long pipelines



Extra power is required when larger and heavier pieces need to be taken care of or need to be transported through long pipelines. Nederman RBU units work uninterruptedly with strong suction and a maintained efficiency. This is the perfect vacuum source in larger systems where powerful vacuum is required to balance for large pressure drop in long pipes or hoses. Many of the Nederman RBU units can operate continuously at -45kPa / 180 in. W.G. and are the optimal vacuum source for heavy cleaning and heavy on-tool extraction. The unique quality of the RBU unit is the combination of an extraordinary suction capacity and a low noise level. This is due to successful design with a 3-lobe roots type blower fitted with unique inlet and outlet silencers, all housed in a heavy insulated acoustic enclosure.

Reliable in operation

Our RBU units are equipped with a highly efficient roots type pump with safety functions such as temperature control, safety valve, back flush valve etc. Other features contributing to reliability are gears in an oil bath and a generously dimensioned motor.

Higher efficiency gives lower energy costs

When vacuum is stronger than -30 kPa / 120 in. W.G., the RBU has 30-35% higher efficiency compared to centrifugal fans or side channel fans (turbo pumps). This gives effective suction at a lower cost.

The heart of the system

The RBU unit together with a dust collector and a PLC controlled starter make a very efficient vacuum system, where start and stop of the unit and filter cleaning are automatic. The system is very easy to use. It starts when the operator opens a valve for suction and stops when all valves are closed. An energy saving idling function is standard fitted. For pre-separation of fluids, metal shavings, coarse waste etc., a Nederman pre-separator will do the job.

- Low noise level
- Easy to service
- Low running costs

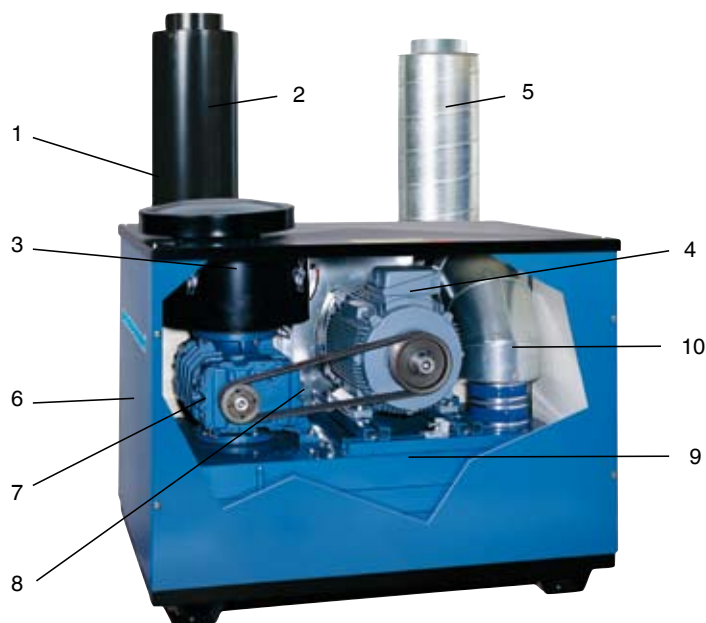

- 1. Noise trap
- 2. 1st inlet silencer
- 3. 2nd inlet silencer
- 4. Motor
- 5. 3rd outlet silencer
- 6. Acoustic enclosure
- 7. 3-lobe roots type blower
- 8. Transmission (Belt guard removed to show details)
- 9. Primary outlet silencer
- 10. 2nd outlet silencer

Accessories

FlexFilter, our modular design dust collector is available in many different options. See separate brochure and selection guide.

PLC controlled starter



FlexFilter Single



FlexFilter Twin

Fan diagram RBU

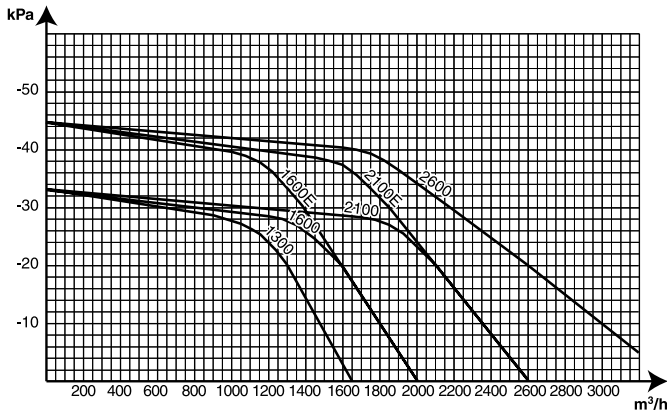

Dimensions Nederman RBU

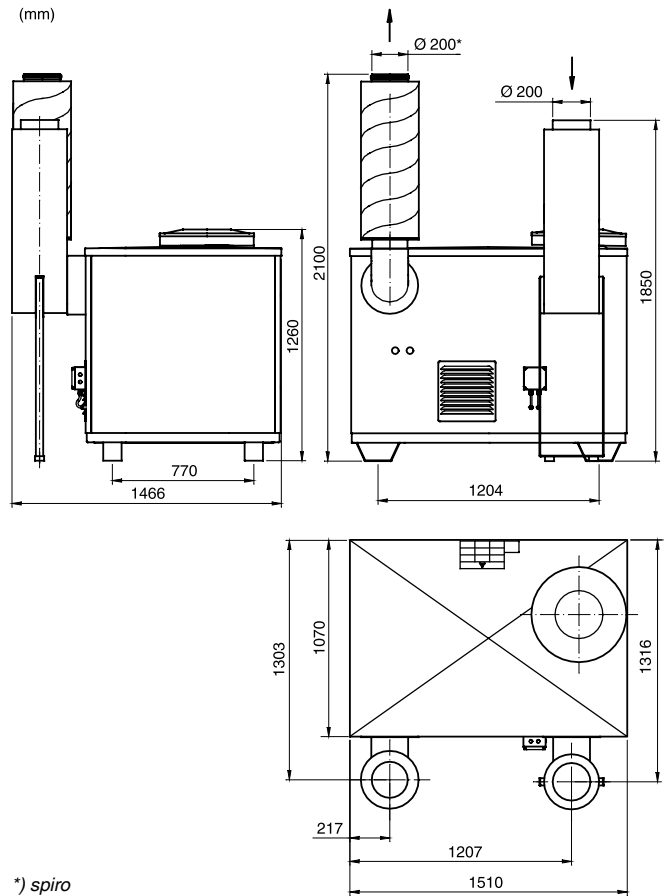

Technical Data

| Vacuum units RBU | | 1300 | 1600 | 1600E | 2100 | 2100E |
|------------------------|------------------------|------------|-------------|-------------|-------------|-------------|
| Weight | kg (lb) | 885 (1951) | 915 (2017) | 975 (2150) | 1115 (2458) | 1150 (2535) |
| Max. vacuum | kPa (in. W. G.) | 33 (132) | 38 (153) | 45 (180) | 33 (132) | 45 (180) |
| Capacity at 20 kPa | m ³ h (cfm) | 1300 (765) | 1600 (942) | 1600 (942) | 2100 (1236) | 2100 (1236) |
| Maximum flow | m ³ h (cfm) | 1650 (971) | 2000 (1177) | 2000 (1177) | 2600 (1530) | 2600 (1530) |
| Motor power | kW | 22 | 30 | 30 | 30 | 45 |
| Noise level, ISO 11201 | dB(A) | 70 | 70 | 70 | 70 | 70 |

| Model | RBU 1300 | RBU 1600 | RBU 1600E | RBU 2100 | RBU 2100E | RBU 2600 |
|---------------|----------|----------|-----------|----------|-----------|----------|
| 230V 50Hz | | | 40105200 | | | 40105500 |
| 400V 50Hz | 40105010 | 40105110 | 40105210 | 40105310 | 40105410 | 40105510 |
| 208-230V 60Hz | 40105030 | 40105130 | 40105230 | 40105330 | 40105430 | 40105530 |
| 460V 60Hz | 40105050 | 40105150 | 40105250 | 40105350 | 40105450 | 40105550 |
| 575V 60Hz | | | 40105260 | | | |

Environmental data

- Solvent-free lacquering.
- Halogen-free (PVC-free) cables.
- High efficiency automatic idling and start/stop give low power consumption.